

Plat of Survey

of

Unit 42 of Phase I of Country Estates,

a condominium located in the Northwest 1/4 of the Northwest 1/4 of Section 8,
Town 2 North, Range 18 East, Town of Lyons, Walworth County, Wisconsin.

Surveyed for: **Ron & Sandy Meyer**
8110 West Allerton Avenue
Greenfield, Wisconsin. 53220

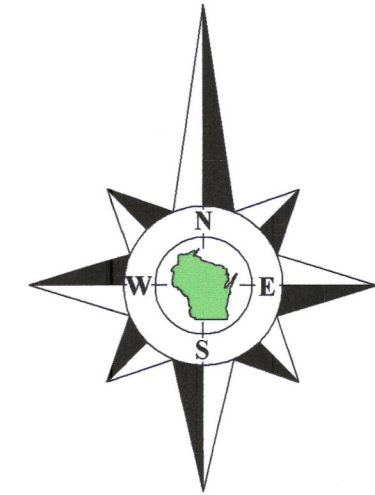
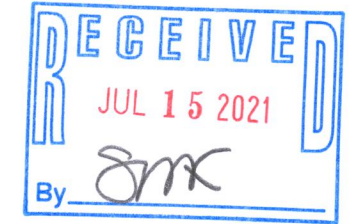

Bearings referenced to the
plat of Country Estates.

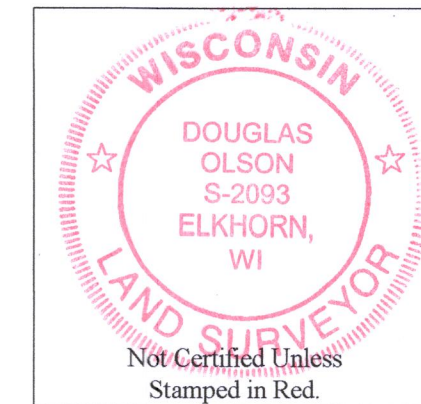

Notes:

- 1) This Plat of Survey is not certified unless signed and sealed in red ink.
- 2) This survey is subject to Wisconsin lien laws. This Plat of Survey is the notice of intent to file lien. Lien waiver required.
- 3) The Survey Date shown on this Plat of Survey is the completion date of the field work.

Copyright 2002 by Jensen & Olson Land Surveying, LLC.

All rights reserved. No part of this survey plat may be reproduced or transmitted in any form by any means - graphic, electronic, or mechanical, including photocopying, tracing, or information storage and retrieval systems - without permission in writing from Douglas G. Olson, Jensen & Olson Land Surveying, LLC.

I, Douglas G. Olson, Wisconsin Registered Land Surveyor, do hereby certify that this survey was performed by me or under my direction in full compliance with the owner's/agent's instructions and Chapter A-E 7 of the Wisconsin Administrative Code "Minimum Standards for Property Surveys"; and that this map is an accurate representation thereof to the best of my knowledge and belief.

Douglas G. Olson
Wisconsin Registered Land Surveyor - 2093

2/18-2/16

Survey Date: May 22, 2002.
Revisions: No. 1 - Proposed Improvements

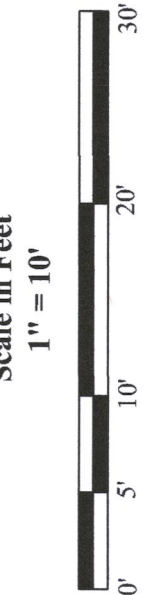

45 South Wisconsin Street | P.O. Box 322
Elkhorn, Wisconsin 53121
Telephone: (262) 723-3434
Facsimile: (262) 723-8044
Email: doug@olsonsurveying.com
Website: www.olsonsurveying.com

OLSON
LAND SURVEYING, LLC
Rural | Residential | Commercial

Legend of Symbols & Abbreviations
Found Iron Pipe
Set Iron Rod, 3/4" dia.
Recorded Information
Utility Pedestal & Panel
Manhole
Asphalt Surface
Concrete Surface

Sheet 1 of 1 Sheets
Drawing Name:
Job Reference Number
2021.018

2021.018

Note:

Revision no. 1 to this Plat of Survey prepared in February 2021 to show proposed improvements. Existing improvements shown based upon original Plat of Survey dated May 22, 2002. Current site conditions not field verified.

NCS-42